

BS[®] Link

Motor (wired/battery powered)



Forest Link RF
Protocol inside



TABLE OF CONTENTS

- Included in the box / accessories
- Declaration of conformity

1. Your BS® Link Motor

- Areas of use
- Important safety and liability information

2. Product info

- Product info
- Installation!
- Power options

3. Instructions

- Control functions

4. Get started

- Tubular motor pairing button functions
- Pairing motor with remote control

5. Settings

6. Installation & connecting bluetooth module

7. Notice

8. Support & technical specification

- Technical information

INCLUDED IN THE BOX

- 1x BS Motor (3636000010)
- 1x Bluetooth Module
- 1x Manual

ACCESSORIES (NOT INCLUDED IN BOX)

- Forest EasyTouch Remote Control (520108X006)
- Set Battery Accessories (3636000002):
 - 1x Battery pack
 - 2x Brackets
 - 1x USB to USB-C cable
- BS Motor 12V Adaptor (1.5mtr) + Extension (2.4mtr) (EU 3636000004 & UK 3636000005)

FEATURES & BENEFITS

- Motor including Bluetooth capabilities
- Works directly with Forest Connect app
- Both cable-operated and battery-powered options available
- 4kg weight load
- Battery charging motor takes 6-8 hours or until the blue light comes on
- Battery motor: 6 month battery life (1 up & 1 down)
- 5 year warranty on motor
- 2 Year warranty on the battery pack

DECLARATION OF CONFORMITY

FOREST
DRAPERY HARDWARE

EU Declaration of Conformity

Hereby we, the undersigned:

Manufacturer: Forest Group Nederland B.V.
Address, city, Country: Teugeweg 42, 7418 AM Deventer, The Netherlands
Telephone number: +31 0570 622850

Declare that this DoC is issued under our sole responsibility and that this product is:

Product description: Electronic motorized curtain track system
Type designation(s): BS Bluetooth Motor (3636000000)
Trademark: Forest
Power Adapter: DZ024EHL120200V
Battery Pack: 300556788

Object of the declaration:



The object is in conformity with the relevant Union harmonization legislation:

EN 60335-1:2012 + A11:2014 + A12:2017 + A13:2019 + A14:2019 + A2:2019 + A15:2021 + A16:2023	
EN 60335-1:2012 + A11:2014 + A12:2017 + A13:2019 + A14:2019 + A2:2019 + A15:2021 + A16:2023	EN 300 220-1 V3.1.1 (2017-02)
EN 50663:2017	EN 300 220-2 V3.1.1 (2017-02)
EN 62233:2008	
Article 3.1(b)	
EN 301 488-1 V2.2.3 (2018-11)	
EN 301 488-3 V2.2.3 (2018-11)	
EN IEC 55014-1:2021	
EN IEC 55014-2: 2021	
EN IEC 61000-3-2:2019 + A1:2021	
EN 61000-3-3:2013 + A2:2021	
EMC Directive - (EU) 2015/863	
Battery directive - (EU) 2021/182	

Signed for and on behalf of:

Place: Deventer Name: A.G. ten Have

Date: 07-01-2025 Function: Head R&D

Signature: 



Forest Link RF
Protocol inside

SUPPORTED PROTOCOL

This BS® Motor is equipped with the Forest Link® protocol.

INTRODUCTION

Thank you for choosing the Forest BS® Link motor. This guide provides essential information on how to operate, maintain, and maximise the performance of your Forest BS® Link motor. In this manual, you'll find step-by-step instructions for usage, charging (if you have chosen a battery-operated option), and troubleshooting, as well as tips to ensure safe and efficient operation.

GENERAL

Please read this manual and the safety instructions carefully before using this Forest product. Follow the instructions in this manual and keep it throughout the entire lifespan of the product. This manual describes the setup and operation of the BS® Link motor. Any use beyond the application scope defined by Forest is not permitted. Ignoring the instructions in this manual voids any liability and warranty from Forest Group.

EN

AREAS OF USE

The BS® Link motor is designed for use with the Forest Roman Blind System.

IMPORTANT SAFETY AND LIABILITY INFORMATION

To ensure safe and proper operation of the BS® Link motor, please follow the instructions in this document as well as the complete manual.

Keep this document close to the product at all times or visit www.forestgroup.com to view it online. Use the product only as intended.

This product is not suitable for use in humid spaces such as bathrooms or outdoors. In order for the BS® Link motor to function correct and safe, the complete Roman Blind System must be assembled with original & undamaged parts and devices of Forest Group (Nederland) B.V.

This product is not suitable for use by children, it is not a toy. Keep (as well the remote control) out of the reach of children at all times. Frequently examine the product for imbalance and signs of wear or damage.

Forest Group does not assume liability for resulting damages to persons, animals and/or property, defects, labour on location, service calls, reinstallation or expenses involved shipping, packing or returning goods, if the product has been abused/modified in any way or damaged by improper use or failure to observe these operating instructions. In such situation, the right to any form of warranty, service and reimbursement of expenses shall cease.

1. This product is for indoor use only, do not use outdoor or in humid environments.
2. Power supply: rechargeable lithium battery 12V
3. The motor will jog during setup, please do not proceed to the next step until jog complete.
4. During setup, if no buttons are pressed for 10 seconds, the motor will exit the setting mode.
5. The motor can be paired with max 10 controllers.
6. Upper & Lower limits cannot be set at the same position, limits saved even power off.
7. The motor runs constantly for at 6 minutes max without any other operation.
8. Do not lift the motor by grabbing and pulling the power wire or the antenna.

2. Product info

PRODUCT INFO

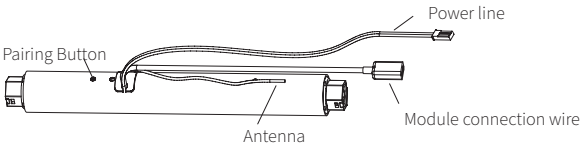

INSTALLATION

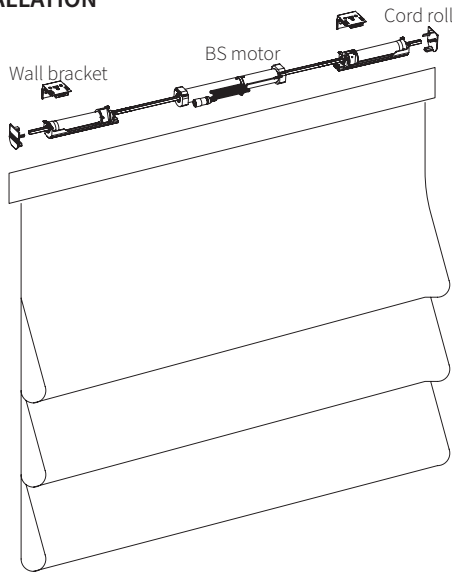

POWER OPTIONS

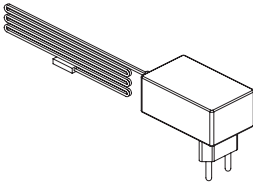

12V Adapter
Art.no. (EU) 3636000004,
(UK) 3636000005

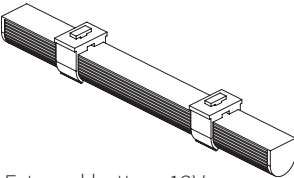

External battery 12V
Art.no. 36360000002

3. Instructions

CONTROL FUNCTIONS

To operate the tubular motor, you need a Forest remote control with the Link protocol (EasyTouch line).

Button EasyTouch		Description/ function
	Open	Opens the curtains or blinds
	Close	Closes the curtains or blinds
	Stop	Stops the movement
	Channel +	Switches to the next channel. The LED indicator moves to the right
	Channel -	Switches to the previous channel. The LED indicator moves to the left
	Favourite	Allows users to quickly access their preferred curtain positions with a single press
	Prg	The Program button, enables users to access programming functions

Note: The P button is located inside the back of the remote control. The method to open the remote may vary depending on the model. Please refer to the specific instructions for your remote type.

4. Get started

TUBULAR MOTOR PAIRING BUTTON FUNCTIONS

Functions	Paring button	Jogging time	Note
OPEN/STOP/CLOSE	Short press	/	Can only be used when limits are already set.
Adding/Removing Controller	Hold for 2s	Jog 1x	Press the P button on the remote control within 10 seconds.
Deactivate RF control	Hold for 6s	Jog 2x	Hold Pairing button for 6s, motor jogs twice to show the motor RF controle is deactivated. To activate again: hold Pairing button for 2s.
Direction Reverse	Hold for 10s	Jog 3x	All other settings remain the same
Reset*	Hold for 16s	Jog 4x	Delete all settings

**Important: Be sure to reset the end positions before using the motor to prevent damage to both the fabric and the motor.*

PAIRING MOTOR WITH FOREST EASYTOUCH REMOTE CONTROL

1: Pairing procedure after assembly

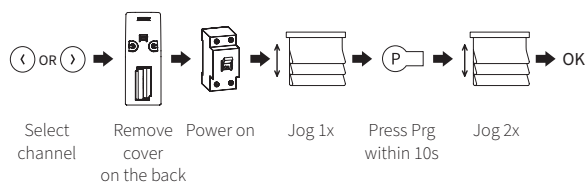

2: Pairing procedure before assembly

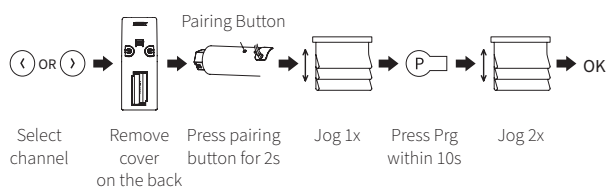

3: Add a new remote using an existing remote (unassembled systems)

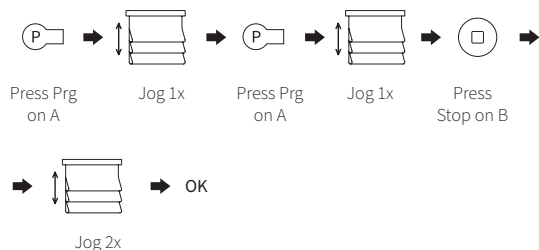

Note: Pairing can not be done under group channel or 0 channel.

EN

5. Settings

DIRECTION REVERSE

The blind moves in the right direction.

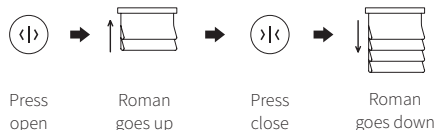

If the limits are not set, and direction goes opposite.

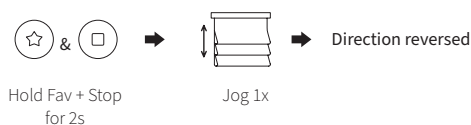

If limits are set and direction goes opposite.

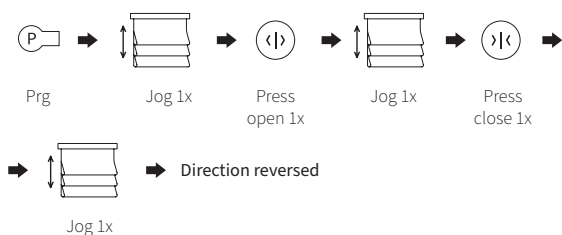

Note: Do reverse the direction when it goes opposite.

UPPER & LOWER LIMITS SETTINGS

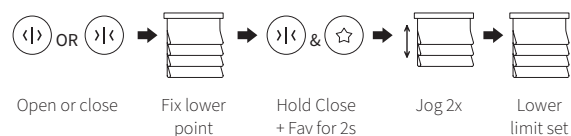

Note: Upper&Lower limits cannot be set at the same point. As long as the end positions have not yet been set, the motor operates in step-by-step mode:

The motor moves as long as you hold down the Open or Close button, and stops as soon as you release it.

Tip: If you hold the Open or Close button for 2 seconds, the curtain will continue to move in one continuous motion until you press Stop.

Once the end positions have been set, the motor will automatically operate in one-touch mode. A single press of Open or Close will activate a continuous movement.

CANCELLING LIMITS

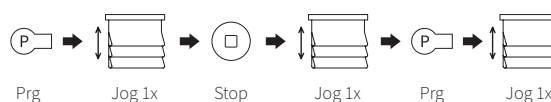

➔ Limits cancelled

Important: Make sure to reset the end positions before using the motor to prevent damage to both the fabric and the motor.

ADJUSTING UPPER & LOWER LIMITS

Adjust Upper limit

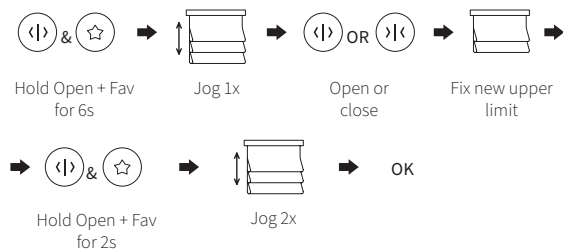

Adjust Lower limit

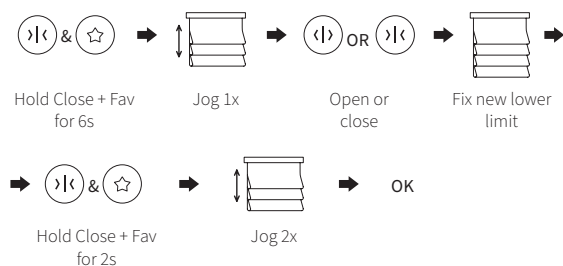

Note: The operation should be done within 4mins.

ADJUSTING MOTOR SPEED

speed increase:

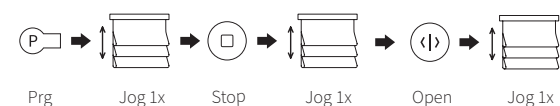

speed decrease:

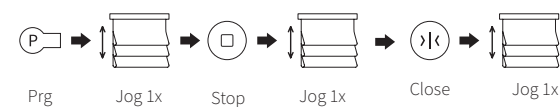

Note: If motor doesn't jog, the max/min speed has already been reached. There are 3 speeds adjustable.

SETTING UP THE FAVOURITE FUNCTION

The Favourite Function allows you to set a preferred position that can be activated with a single press of a button.

Setting the Favourite Function

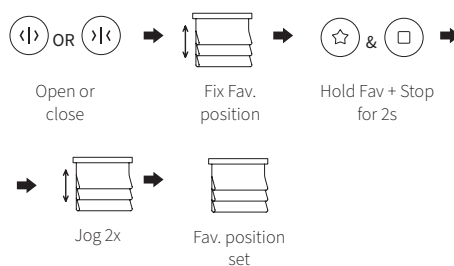

Important: The Favourites function can only be set if the end positions are configured.

Cancelling Favourite function

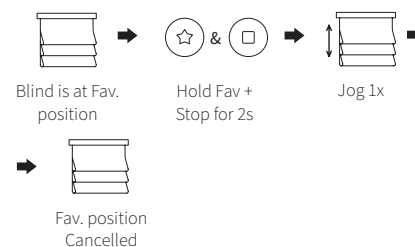

SWITCHING BETWEEN CONSTANT TOUCH MODE AND ONE-TOUCH MODE

Once the end positions are set, the motor operates in one-touch mode (the curtain moves in a continuous motion). To switch to step-by-step mode, follow these steps:

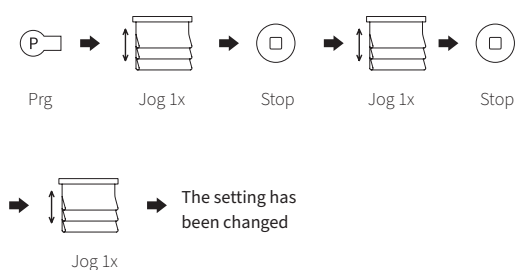

Same operation can toggle from step-by-step-mode to one-touch-mode.

Note: When the motor is in step-by-step mode, it is also possible to fully open or close the curtain in one smooth motion by holding the Open or Close button for more than 2 seconds.

UNPAIR REMOTE CONTROLS

Unpair a single remote control

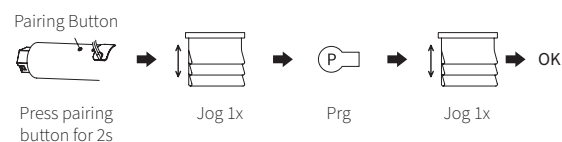

Unpair remote control B via pre-existing remote control A

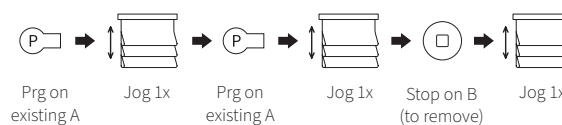

Remote control B unpaired

Unpair all remote controls

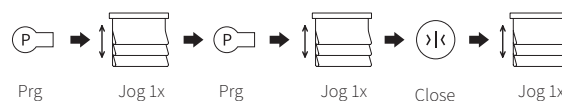

All remote controls unpaired

Note: All other settings, except paired remote controls, remain the same.

EN

6. Installation & connecting bluetooth module



- Working voltage: 3V~3.6V
- Supporting protocol: 802.11B/G/N20
- Working Temperature: 0 - 40 C
- For Indoor Use only

DOWNLOAD APP



- Search "Forest Connect" in the app store or scan the QR-Code.
- Complete account registration and login to the app

INSTALL BLUETOOTH MODULE FOR APP CONTROL

- Power on, insert Bluetooth module to motor module connection wire

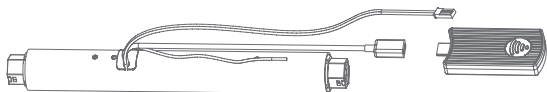

- Wait for 10s to see if the indicator is blinking.



- If indicator didn't blink, please try:
Method 1: Long insert RESET button until indicator blinking, motor's ready to Bluetooth connection.

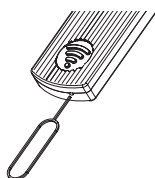

The pin is not supplied. A paperclip or similar tool may be used instead.

Note: Wait for 10s to see if the indicator is blinking.

Method 2: Short Press Prg on back of controller, motor jogs once; short press Down, motor jogs once, then short press UP, motor jogs once and blue indicator blinks which means motor enters Bluetooth connection status.

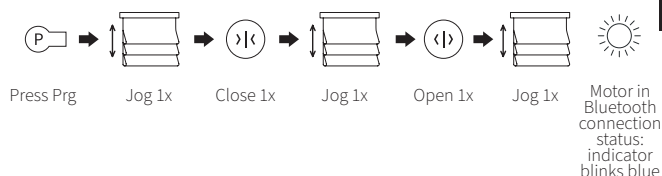

- Find the added Bluetooth gateway on the "Forest Connect app" App, click "+" to add a subdevice, and then click "LED already blink", the APP will automatically search for motor device.

- After adding successfully, click to modify the device name.

- The Bluetooth module indicator is always on after successful network connection.



- Enter the main interface to control the operation of the BS Link tubular motor.

7. Notice



RECYCLING

Do not dispose of the product with household waste. Ensure that you return it to a collection point or depot for recycling purposes.

FAQ

Why isn't the motor working?

- Check if you have paired a remote control. If your remote is not paired yet you need to pair the remote control with the motor by following the pairing instructions in this manual.
- Check if the motor is activ. If the motor is inactive, you can reactivate it by pressing the pairing button twice (poke the button 2 times) to activate the motor.

Why does the motor stop suddenly during operation?

- Check if the upper and lower limits are set correctly. If not, re-set the upper and lower limits according to the instructions in this manual.
- Check if the tubular motor doesn't exceed the rated load. In that case, reduce the load on the motor by adjusting the fabric and checking whether it falls within the specified weight limits.

Why does the motor only move in one direction?

- Check if the motor's limits are set correctly. If they are incorrect, then cancel the original limits and set new upper and lower limits following the instructions in this manual.

TECHNICAL SPECIFICATION

• Voltage	12Vdc
• Power max.	9.6W
• Current max.	0.8A
• Torque	0.8Nm
• Speed	20/30/40
• Run time max.	6 minutes
• Length	20.8cm
• Diameter	24mm
• Frequency	433.92MHz
• RF range (max.)	30m
• Protection degree	IP20
• Temperature	0 - 40°C
• Weight load fabric	4 kg
• Battery charging time	6-8 hours (blue light on = fully charged)

The images in this document are not binding.

EN

**SCAN FOR
DIGITAL MANUAL**



www.forestgroup.com/en/downloads/technical-documents